

**Challenger**

**Microcut**

# VERTICAL MACHINING CENTER MCV-2414 / MCV-2418



ISO 14001:2004  
EMS 546518



ISO 9001:2008  
FM 538421

Feb. 2011

**Challenger**

# MCV-2414 / MCV-2418



*Photo shown MCV-2414*



*Photo shown MCV-2418*



Big door and window



Large outlet for chips and coolant



10000rpm rigid spindle with built-in coolant system (MCV-2418)

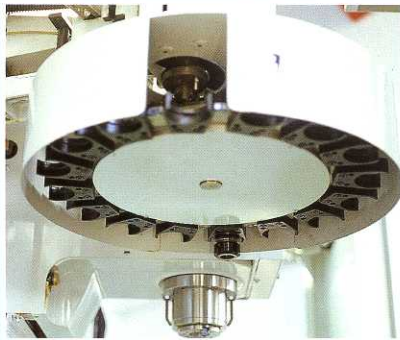

16 pockets ATC-carousel type (MCV-2414)



16 pockets ATC-arm type (MCV-2416)



Chip auger (option)

## Machine features

- CNC controller
- Large fully ground work table with 4T slot
- Precision ground ball screw
- Fully ground way mating surfaces with Turcite B
- Heavy duty metal enclosure with removable side doors for long pieces and easy cleaning
- Radius shape sheet metal
- Front-lower portion of the door rail inside so that the operator doesn't dirty clothes when approaching the work piece
- Heavily ribbed cast iron components
- ISO 40 spindle
- Automatic lubrication with low lubrication fault
- Coolant system with check valve & meter valve

- 16 pockets ATC-carousel type for MCV-2414, ARM type for MCV-2418
- Large outlet for chips & coolant water enable recycle running smoothly
- Chip drawer (ready for chip auger/ chip conveyor facility)
- Telescopic way covers for X & Y axes
- 8000rpm rigid spindle (MCV-2414); 10000rpm rigid spindle (MCV-2418)
- Low voltage circuit system
- CE declaration
- Rigid tapping

## Machine options

- Wash down device
- 4th axis rotary table & device
- Coolant through spindle with 20 bar high pressure pump
- Chip conveyor & bucket
- Chip auger & bucket
- 4 bar high-pressure pump for spindle coolant
- Top cover for full splash guard



Fanuc

Fagor

Heidenhain

Siemens

## Lay out (MCV-2414) (MCV-2418)

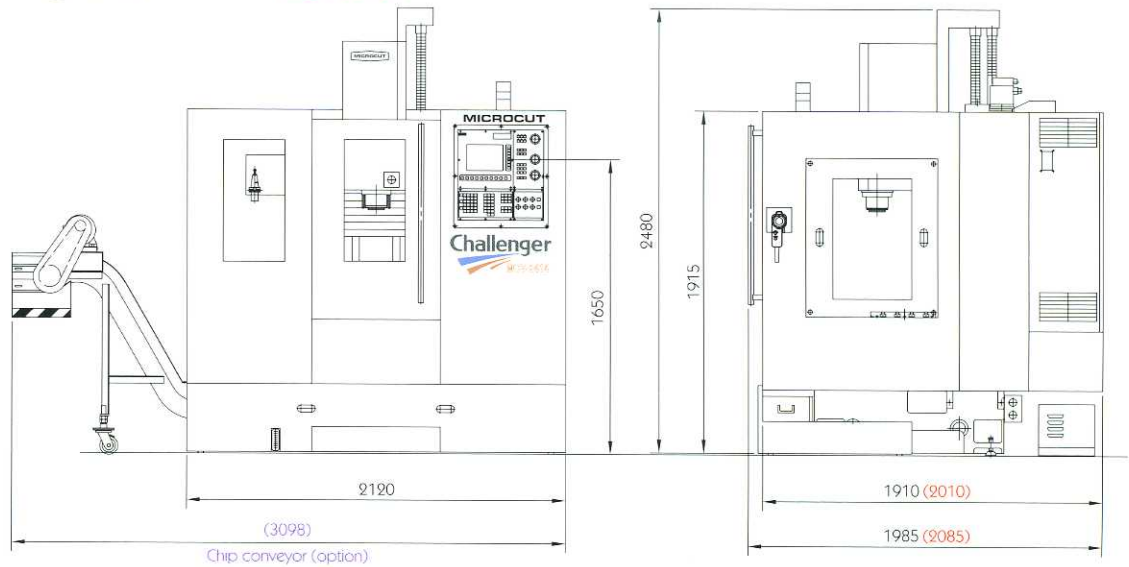

## Horsepower / Torque Charts (Fanuc spindle motor)

Horsepower Chart (MCV-2414)

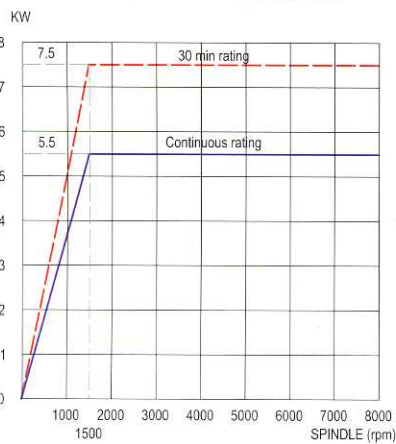

Torque Chart (MCV-2414)

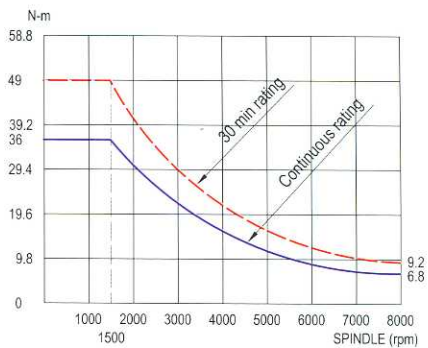

Horsepower Chart (MCV-2418)

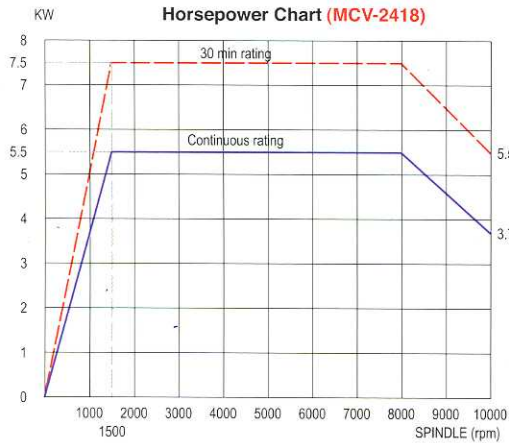

Torque Chart (MCV-2418)

